

LOC	DISP	REVISIONS				
CM	00	REV	DESCRIPTION	DATE	BY	APPD
		HI	REVISED PER ECO-11-004587	11MAR2011	AK	HMA

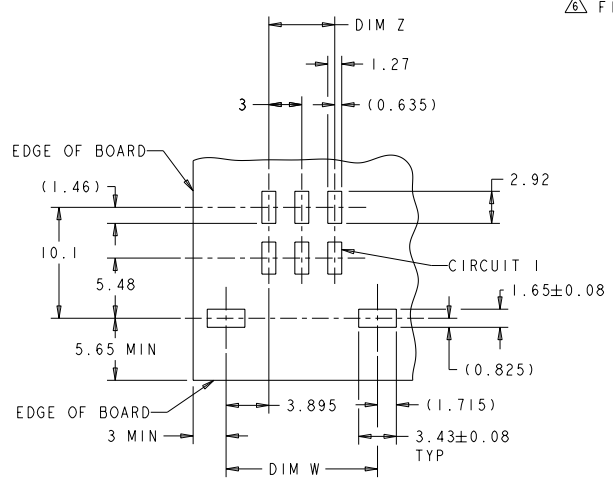

RECOMMENDED PCB LAYOUT (COMPONENT SIDE)

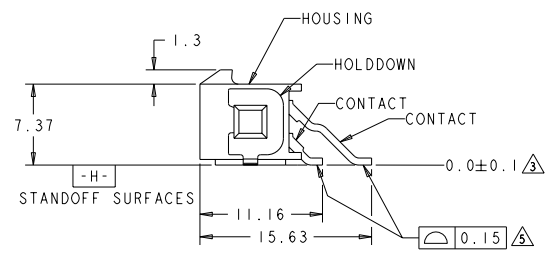
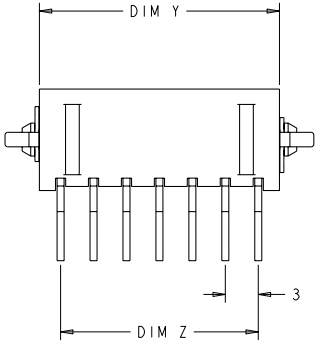
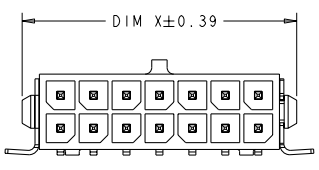
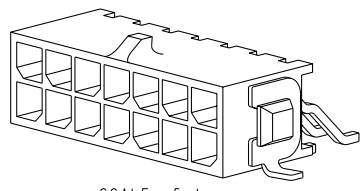

SCALE 5:1



- △ MATERIAL;
CONTACTS - BRASS.
HOUSING - UL 94V-0 RATED HIGH TEMP NYLON,
COLOR: BLACK.
HOLD DOWNS - PHOSPHOR BRONZE.
- △ FINISH;
CONTACTS - 2.54µm MINIMUM TIN-LEAD OVER 1.27µm MINIMUM NICKEL.
HOLD DOWNS - 2.54µm TIN-LEAD.
- △ DIMENSION APPLIES TO SOLDERTAIL SURFACES AND STANDOFF SURFACES.
- △ RECOMMENDED PC BOARD THICKNESS OF 1.57.
- △ ALL SOLDERTAILS AND HOLD DOWNS.
- △ FINISH;
CONTACTS - 2.54µm MINIMUM MATTE TIN OVER 1.27µm MINIMUM NICKEL.
HOLD DOWNS - 2.54µm MINIMUM MATTE TIN.

△	36.86	40.79	33.00	40.00	24	5-794627-4
	33.86	37.79	30.00	37.00	22	5-794627-2
	30.86	34.79	27.00	34.00	20	5-794627-0
	27.86	31.79	24.00	31.00	18	4-794627-8
	24.86	28.79	21.00	28.00	16	4-794627-6
	21.86	25.79	18.00	25.00	14	4-794627-4
	18.86	22.79	15.00	22.00	12	4-794627-2
	15.86	19.79	12.00	19.00	10	4-794627-0
	12.86	16.79	9.00	16.00	8	3-794627-8
	9.86	13.79	6.00	13.00	6	3-794627-6
	6.86	10.79	3.00	10.00	4	3-794627-4
	3.86	7.79	-	7.00	2	3-794627-2
△	36.86	40.79	33.00	40.00	24	2-794627-4
	33.86	37.79	30.00	37.00	22	2-794627-2
	30.86	34.79	27.00	34.00	20	2-794627-0
	27.86	31.79	24.00	31.00	18	1-794627-8
	24.86	28.79	21.00	28.00	16	1-794627-6
	21.86	25.79	18.00	25.00	14	1-794627-4
	18.86	22.79	15.00	22.00	12	1-794627-2
	15.86	19.79	12.00	19.00	10	1-794627-0
	12.86	16.79	9.00	16.00	8	794627-8
	9.86	13.79	6.00	13.00	6	794627-6
	6.86	10.79	3.00	10.00	4	794627-4
	3.86	7.79	-	7.00	2	794627-2
FINISH	DIM Y	DIM W	DIM Z	DIM X	NO. OF POSN.	ASSEMBLY

THIS DRAWING IS A CONTROLLED DOCUMENT. DATE: 23-MAR-2005
 DESIGNED BY: HOOPER DATE: 23-MAR-2005
 CHECKED BY: JONES DATE: 23-MAR-2005
 APPROVED BY: JONES DATE: 23-MAR-2005

TE Connectivity

NAME: SURFACE MOUNT, RIGHT ANGLE, SURFACE MOUNT HOLD DOWN ASSEMBLY, TIN HEADER, DUAL ROW, MICRO MATE-N-LOK (TM)

APPLICATION SPEC: OPTIMISTIC SPECIFICATIONS

WEIGHT: -

SHEET: A200779 CASE CODE: 794627 DRAWING NO: 794627

RESTRICTED TO: -

SEE TABLE CUSTOMER DRAWING SCALE: 4:1 SHEET: 1 OF 1 REV: HI